

Unless otherwise specified $\nabla 6$

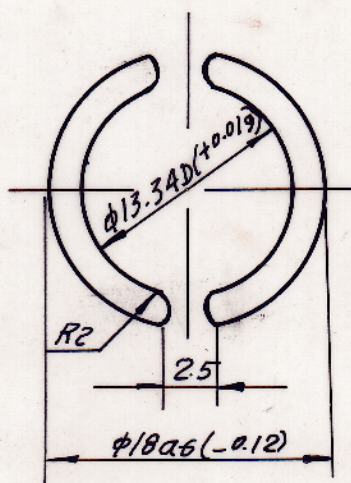
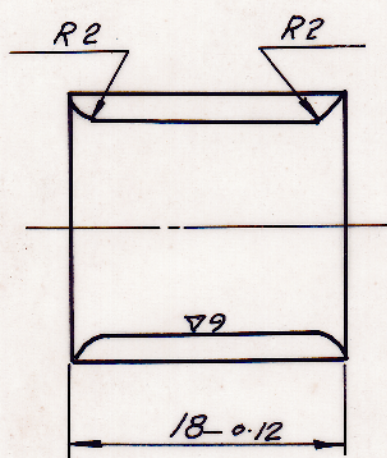

1. Harden to HRC55~62.
2. $\phi 13.34D$ and $\phi 18$ shall be inspected before slitting.

Plug gauge	T13.34L0K21-1		
Plug gauge	Z13.359L0K21-1		
NAME	MARKING		
GAUGE FOR INSPECTION			
	GOK22		
	STRIPPER, 1ST TRIMMING		SCALE
			2:1
	T10A YB5-59		

12/100-38 2/22 ct. 0.01mm